

STS SERIES INSTALLATION INSTRUCTIONS

STS TANK SYSTEM

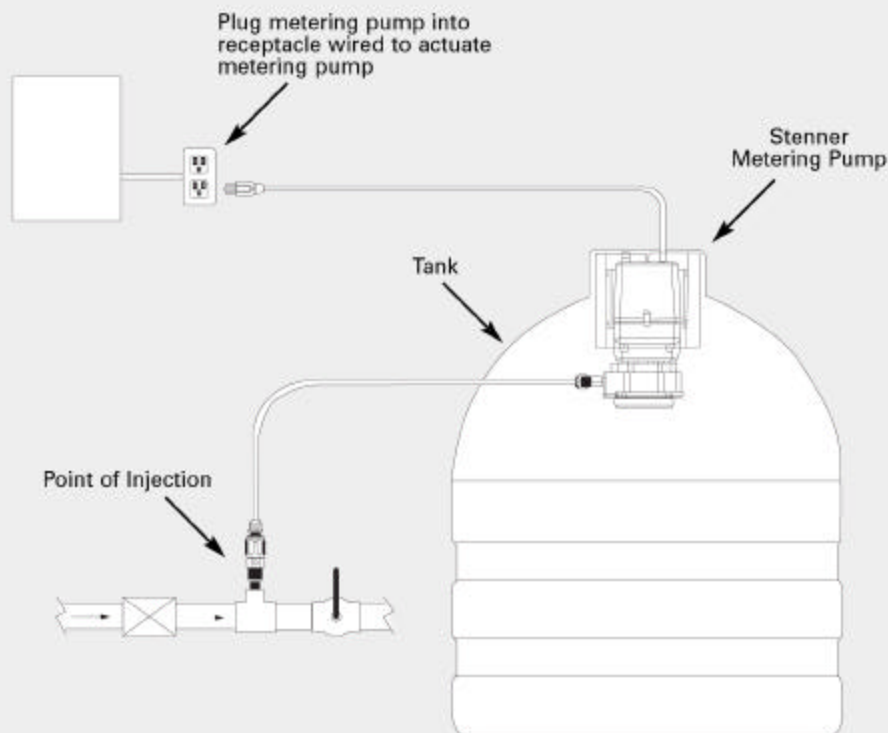

INSTALLATION

- Locate the tank within 10 feet of the point of injection.
- Install the injection fitting or injection check valve assembly.
- Install the discharge tubing from the pump tube to the point of injection.
- Connect the power cord to the proper pump control circuit receptacle.
- Connect suction line to pump. (Disconnected for shipment)
- Fill the tank with the solution to be injected. Make sure the lid is tightened when finished.
- Prime the metering pump and perform final output adjustments.

PLEASE NOTE: The STS Tank System comes with screws installed into each side of the mounting bracket to prevent shipping damage. Please remove these fasteners upon installation so that the pump may be removed from the mounting bracket when required.

Refer to the Installation & Maintenance Manual for the metering pump included with all tank systems for more information regarding the proper installation and care of your new chemical metering pump.



3174 DeSalvo Road
Jacksonville, Florida 32246
sales@stenner.com
www.stenner.com
Phone: 904-641-1666
US Toll Free: 800-683-2378
Fax: 904-642-1012, 800-329-1339
Hours of Operation (EST):
Mon. – Thu. 7 AM – 5 PM
Friday 7 AM – Noon